

Mendenhall Cemetery Association  
 How to Mark a Grave Site  
 Procedure

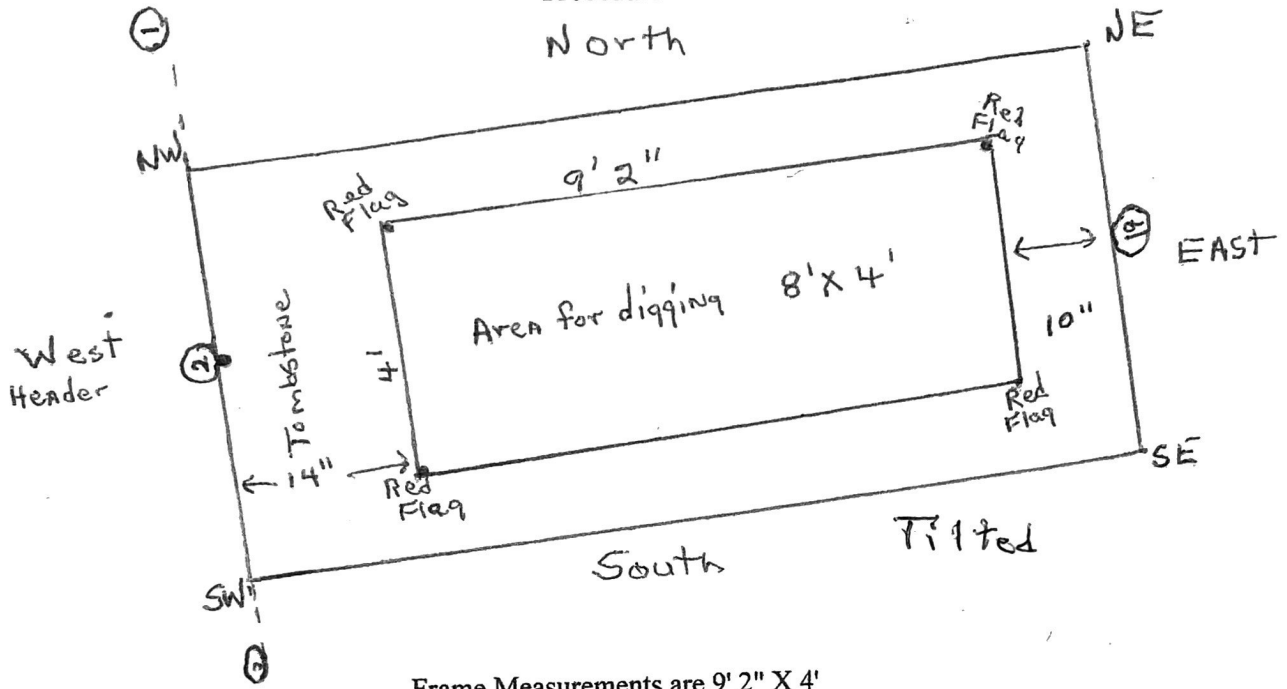

Frame Measurements are 9' 2" X 4'

1. Stretch the string on the ground along the head of the marker where the grave is to be opened, extending to the markers above and below said grave site. String should be stretched along the east side of the three markers.
2. Place the frame in line with the string at the center point of the grave site.
3. The first 14 inches will be the area reserved for the tombstone.
4. The frame will be marked by tape placed on the frame where red flags will identify the area to be marked.
5. The flagged area should measure 8' in length and 4' in width.

3. Grave digger Already know this